

# Techn. Daten: Nice

Bohlenaußenmaß (B x T): 300 x 575 cm

Wandaußenmaß: 280 x 555 cm · Bohlenstärke: 40 mm

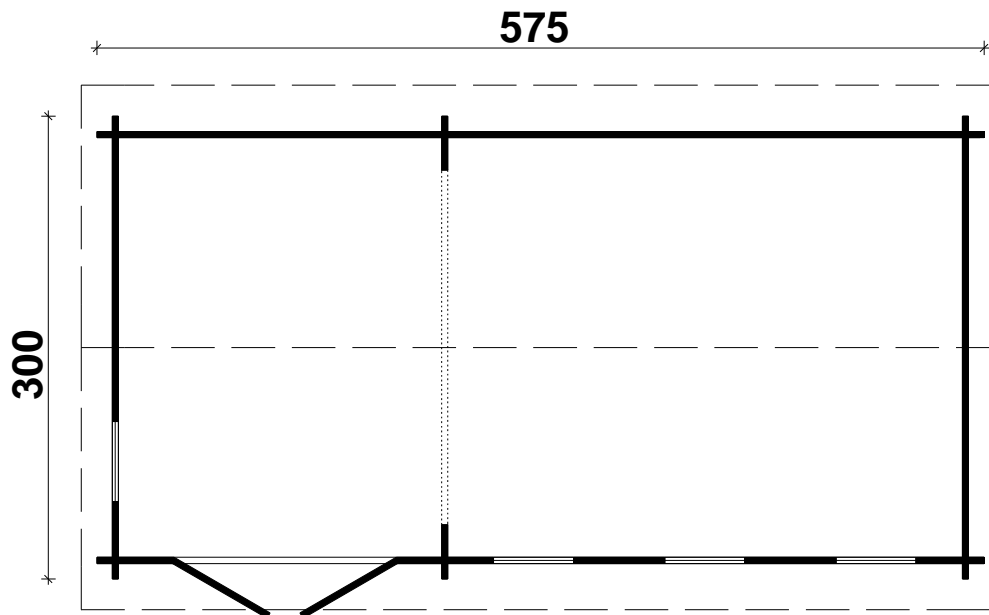

Achtung : Alle angegebenen Maße sind ca. - Maße !

# Teileliste Nice 40 mm / 300 x 575 cm

Nr.	Beschreibung	Profil mm	Länge mm	Stück	
001	Fundamenthölzer		2790	2	
002			5400	6	
003			474	6	
004			5750	1	
005			500	1	
006			3810	1	
007			3000	21	
008			3000	1	
009			3000	1	
010			5750	19	
011			1980	16	
012			500	33	
013			440	17	
014			350	34	
015			630	17	
016			590	34	
017			550	2	
018	Giebel 			3000	3
019				5950	2(1+1)
020				5950	1
021			5950	2	
022	Doppeltür ca. 1425 x 1955mm - 40 mm			1	
023	Einzelfenster ca. 515 x 1890mm - 40 mm			4	
024	Fußbodenbretter		2717	50+1	
025	Fußleisten		ca. 25,0 m		
026	Dachpappe		6050	5	
027	Dachbretter		1770	110+2	
028	Giebelblende		1810	4	
029	Giebelabschlussbrett		1810	4	
030	Traufenbrett		5950	2	
031	Traufenleiste		2975	4	
032	Raute			2	
033	Sturmleisten		2150	8	
034	Schloßschrauben M 8 x 70, Mutter, Scheibe			24	
035	Nägel 2,2 x 50			1 Beutel	
036	Dachpappnägel 2.8 x 15			1 Beutel	
037	Schrauben 4,0 x 40; 5,0 x 70			1 Beutel	
038	Schlaghölzer		300-400		

# Nice 40 mm / 300 x 575 cm

## Fundamentplan

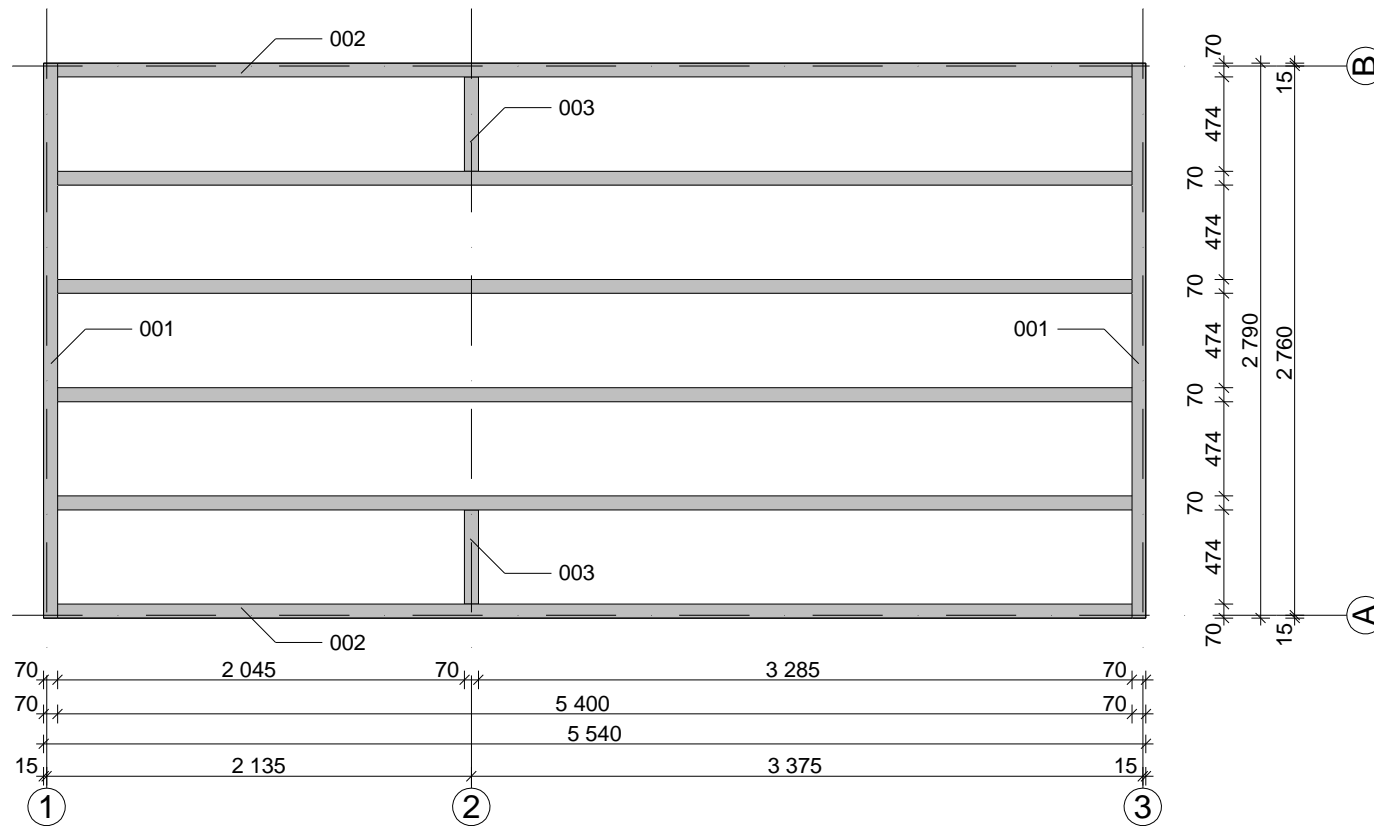

# Nice 40 mm / 300 x 575 cm

## Wandplan

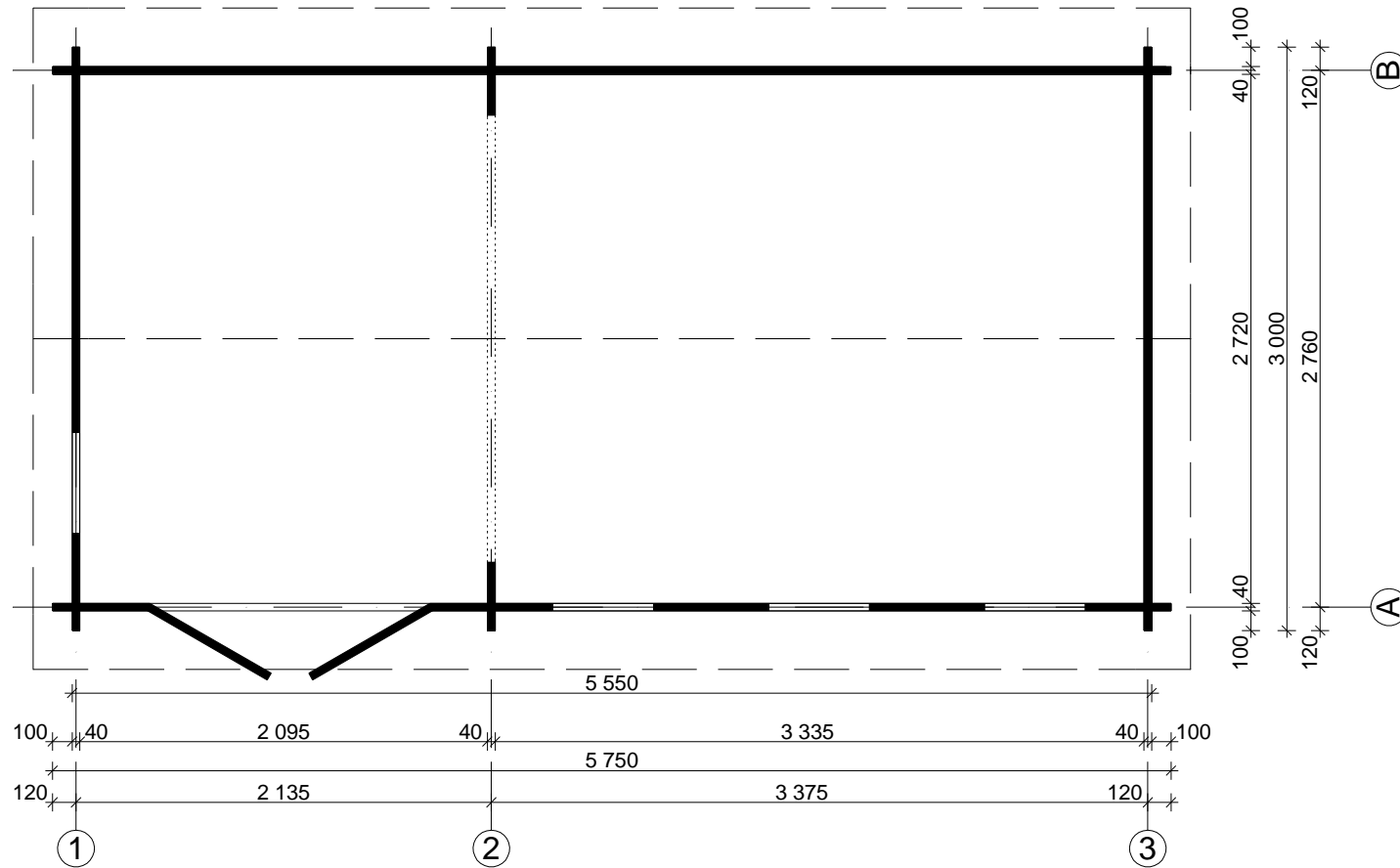

# Nice 40 mm / 300 x 575 cm

**1**

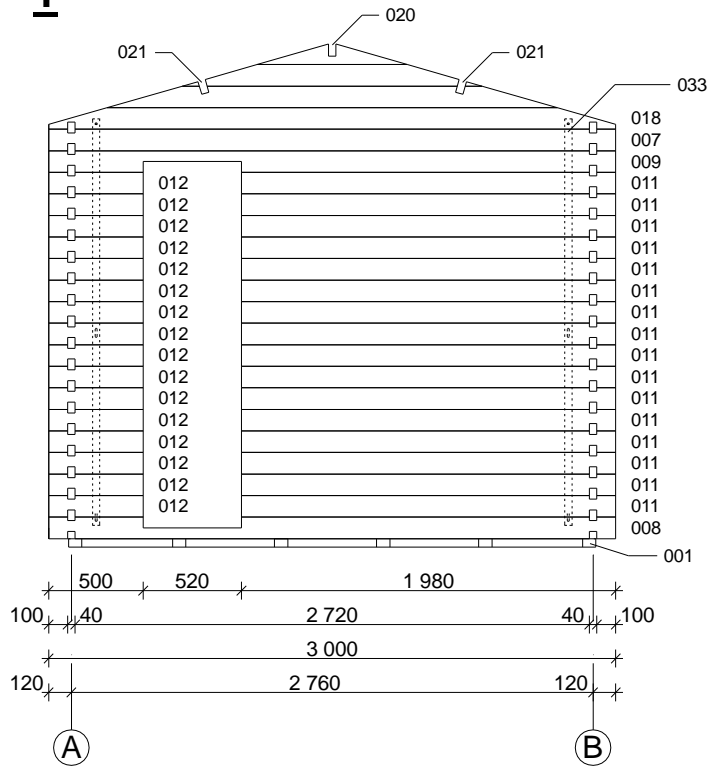

**2**

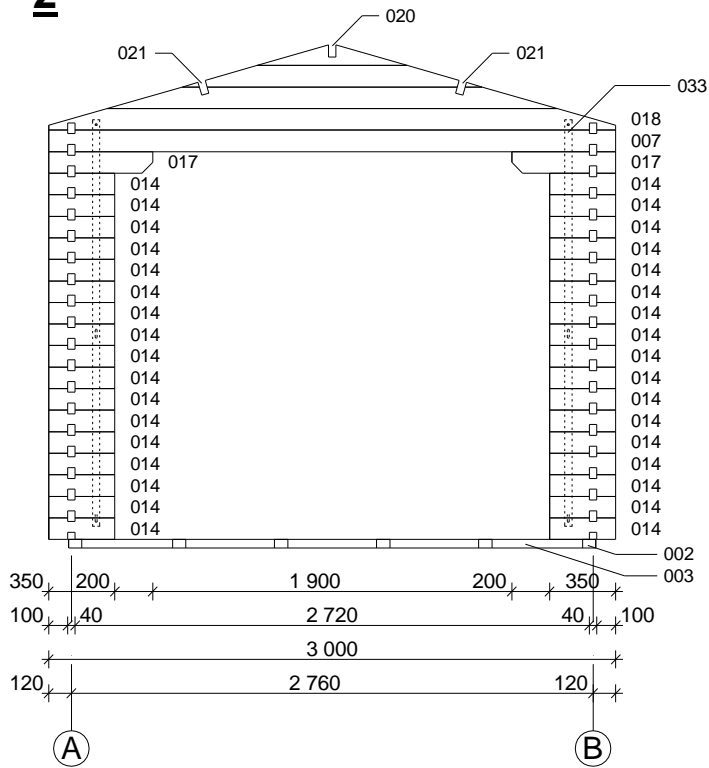

# Nice 40 mm / 300 x 575 cm

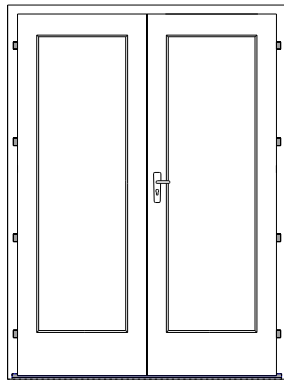
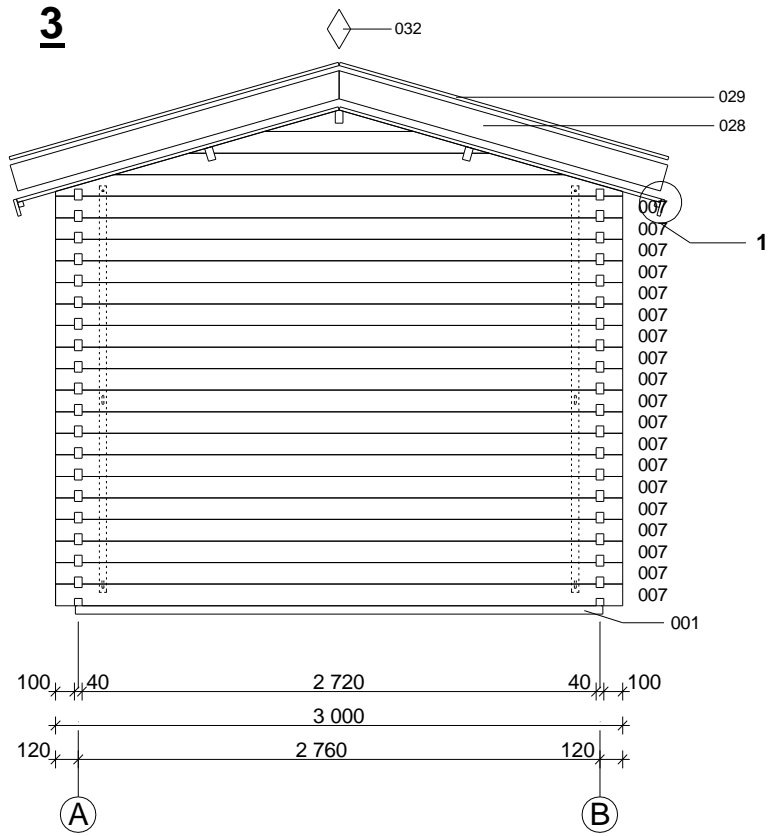

**Doppeltür**  
40 mm  
1425 x 1955 mm  
1 st.

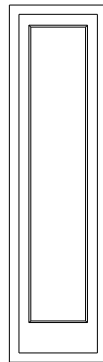

**Einzelfenster**  
40 mm  
515 x 1890 mm  
4 st.

# Nice 40 mm / 300 x 575 cm

**A**

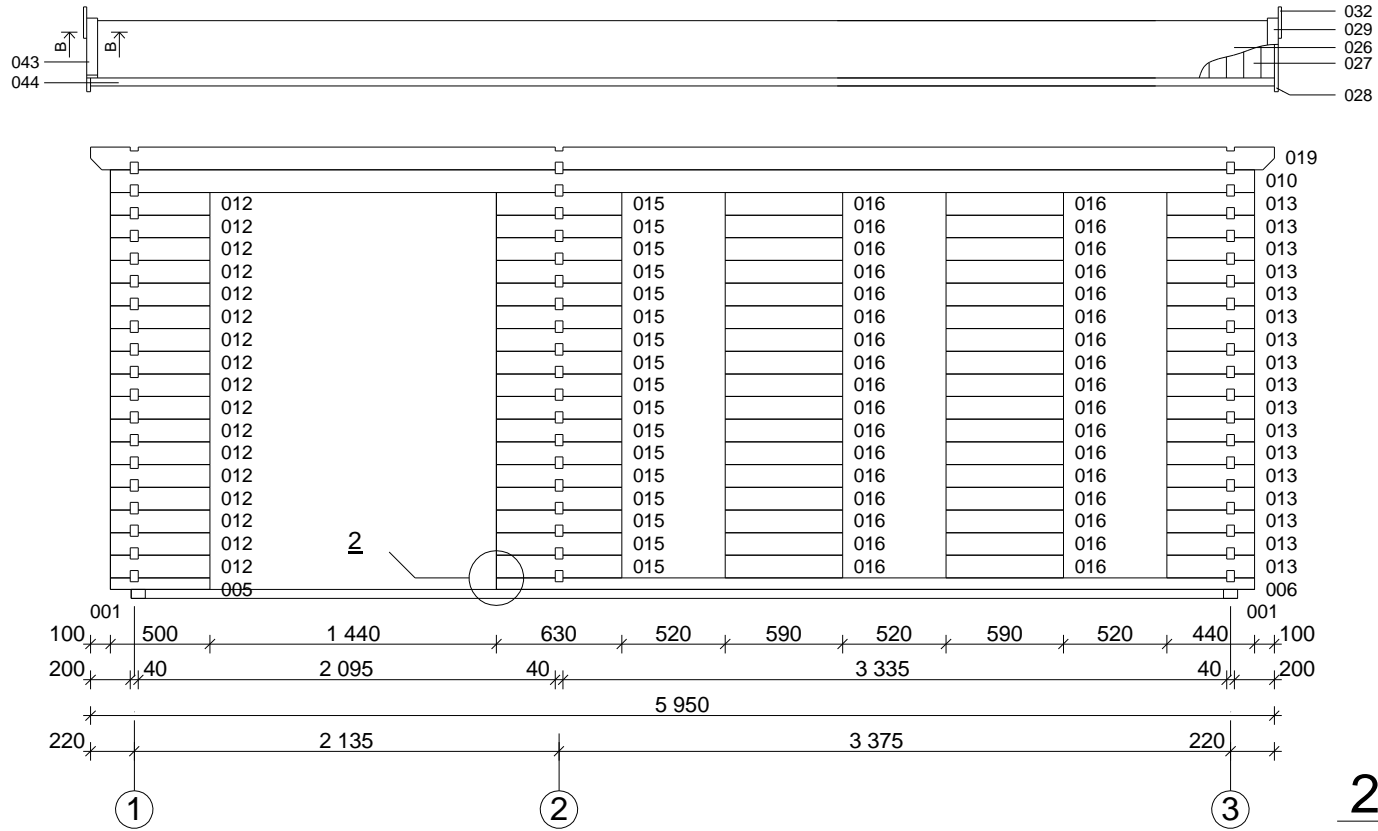

**A-A**

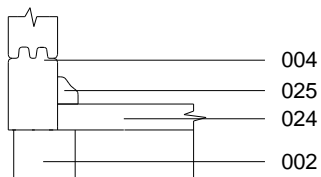

**B-B**

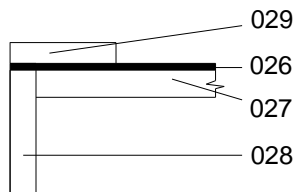

**1**

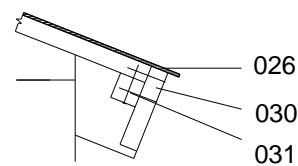

**2**

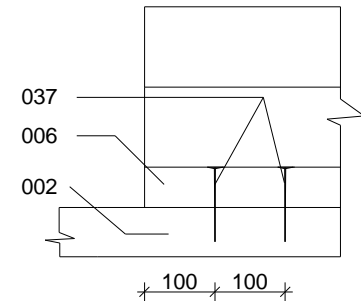

# Nice 40 mm / 300 x 575 cm

**B**

